

# LISTA RICAMBI - SPARE PARTS LIST - LISTA PIEZAS DE REPUESTO



TYPE OF EQUIPMENT

MODEL

**NOVA 260N TURBOCAR 230/400V**

REF FM	PAGE No. 1 of 1	CODE	99200085	WIRING DIAGRAM	S9200081	PARTS DRAWING	E9200142	DATE	18/04/2011
--------	-----------------	------	----------	-------------------	----------	------------------	----------	------	------------

No.	P/N	DESCRIZIONE ARTICOLO	ITEM DESCRIPTION	DESCRIPCIÓN DEL ARTÍCULO	QTY
01	22610012	LAMPADA SPIA ARANCIO 220V+NORME L=210	ORANGE PILOT-LAMP 220V L=210	LUZ PILOTO NARANJA 220V L=210	1
02	21690015	MANOPOLA D.34 X COMMUTATORE PERNO 5 MM	SWITCH KNOB D.34	POMO PARA CONMUTADOR D.34	1
03	21800057	VOLANTINO 3 LOBI D.80 PERNO D.8 SPOR.135	3 LOBES D.80 HAND-WHEEL 135MM	VOLANTE D.80	1
04	33710061 9005	FRONTALE SALD.VENTILATA 180A T.N. NERO	FRONT PANEL WELDER 180A BLACK	PANEL FRONTAL	1
05	33705393 3020	MANTELL.VENTILATA MANIGLIA CURVA ROSSO	COVER PANEL	COBERTURA	1
06	04600151	KIT VENT.JONS.ROVES.P.12 230V VENT.D.120	FAN MOTOR COMPLETE 230V	VENTILADOR COMPLETO	1
07	21600035	MANIGLIA AD INCASTRO CURVA X PORTATILI	HANDLE	MANILLA CURVA	1
08	22210019	TERMOSTATO 127° 25A * ROSSO	THERMOSTAT 127° 25A	TERMOSTATO 127° 25A	1
09	44110300	TRASFORMAT. NOVA 260 230/400V 40X105AL	TRANSFORMER 230/400V 40X105AL	TRANSFORMADOR 230/400V 40X105AL	1
10	33800029	MOLLA A 'C' BLOCCA SHUNT PORTATILI	"C" TYPE SPRING FOR SHUNT	MUELLE A 'C'PARA SHUNT	2
11	21690386	BANDIERINA X SHUNT PRESSOIMP."ALTA" PBT	INDICATOR X SHUNT	INDICADOR PARA SHUNT	1
12	33725015 9005	MANICO MIG 120 CARRELLATE NERO	HANDLE-EXTENSION FOR MIG W/WHEELS	MANIJA NEGRA	1
13	21610018	TAPPO COPRITESTA X TUBO OVALE 12X25	CAP FOR OVAL TUBE 12X25	TAPON PARA TUBO OVAL 12X25	1
14	55200037	ASSE X RUOTE D.8 L=320 ZINCATO-33630037	WHEELS - AXLE D.20 L=320	EJE PARA RUEDAS D.20 L=320	1
15	21610022	PIEDINO SX PORTATILE - CARRELLATA	LEFT FOOT	PIE IZQUIERIDO	1
16	04600022	KIT MORSETTO LOBATO NERO C/ROND.FRANCESE	COMPLETE BLACK CONNECTOR	CONNECTOR NEGRO COMPETO	2
17	21610021	PIEDINO DX PORTATILE - CARRELLATA	RIGHT FOOT	PIE DERECHO	1
18	21625034	RUOTA D.125 PLASTICA FORO D.8 5 RAZZE	WHEEL D.125 RUBBER HOLE D.8	RUEDA D.125 PLASTICO FORO D.8	2
19	20220022	CAVO PVC 3X2,5 MT.2,5 SPINA SHUCO	INPUT CABLE 3X2,5 M 2,5 WITH SHUKO PLUG	CABLE DE ALIMENTACION 3X2,5 M 2,5	1
20	04600234	PRESSACAVO HELVI X CAVO D.10+VITE AUTOF.	CABLE CLAMP D.10 + SCREW	PRENSA CABLE X CABLE D.10+VITE AUTOROSC.	1
21	33700035 9005	FONDO PORT.VENTILATA T.N. NERO	BOTTOM PANEL	FONDO	1
22	33800028	MOLLA PER VITE DI REGOLAZIONE PORTATILI	SPRING FOR REGOLATION SCREW	MUELLE PARA TORNILLO DE REGULACION	1
23	41415019	BLOCCHETTO PRESSOIMP. SHUNT 39X108 H=9,2	SHUNT 39X108 H=9,2	SHUNT 39X108 H=9,2	2
24	22320015	COND.R46.50 MKPX2 0,68MF275VAC P.22,5 RL	CAPACITOR R46.50 MKPX2 0,68MF275VAC	CONDENSADOR R46.50 MKPX2 0,68MF275VAC	1
24	26030173	RESISTENZA 1M OHM 1/2W 5% ST.CARBONE	RESISTANCE 1M OHM 1/2W 5%	RESISTENCIA 1M OHM 1/2W 5%	1
25	33815010	GIOGO STAMPATO X LAM.39 PRESSOIMPACCO	SHUNT YOKE X LAM.39	JUEGO	1
26	22205130	COMMUTATORE 17A CS017 9171170	SWITCH 17A CS017 9171170	CONMUTADOR 17A CS017 9171170	1

**PROPRIETA' ESCLUSIVA & CONFIDENZIALE:** questo documento contiene informazioni riservate di proprietà esclusiva di HELVI S.p.A. e non può essere duplicato o inviato a parti terze o usato per altri scopi senza il previo consenso scritto di HELVI S.p.A.

**PROPRIETARY & CONFIDENTIAL:** this document contains proprietary and confidential information owned by HELVI S.p.A. and may not be duplicated, communicated to other parties or used for any purpose without express written permission of HELVI S.p.A.

**PROPIEDAD EXCLUSIVA Y RESERVA:** este documento contiene informaciones reservadas de propiedad exclusiva de HELVI S.p.A. Copia, distribución a terceros y/o utilizzo en cualquier forma sin el permiso expreso por escrito de HELVI S.p.A. están prohibidos.

HELVI S.p.A. si riserva il diritto di modificare qualsiasi informazione qui sopra senza preavviso a seguito di possibili migliorie ai propri prodotti. Questo documento, le informazioni qui riportate e/o allegate sono soggetti alle condizioni generali di vendita in vigore con Voi.

Due to constant improvements HELVI S.p.A. reserves the right to amend any of the above without prior notice. This document, the reported and/or enclosed information are subject to the trading terms and conditions in force with you.

A causa de mejoras en sus productos HELVI S.p.A. se reserva el derecho de modificar cualquier información en este documento sin previo aviso. Este documento, las informaciones referidas y/o adjuntas están sujetos a las condiciones generales de venta vigentes con Uds.

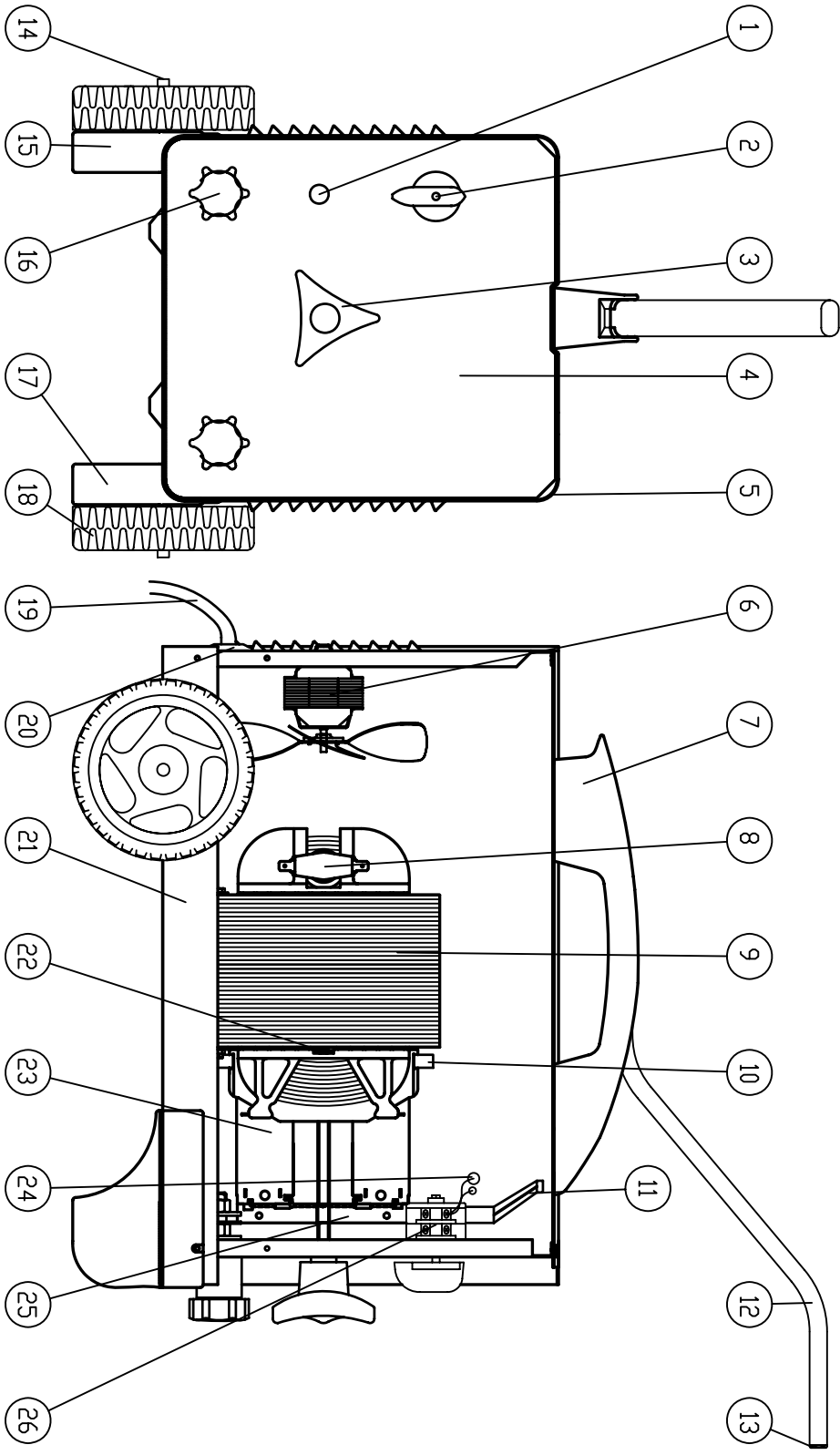

Denomination

NOVA 260N

Date

24.04.09

Part Number

E9200142



PROPRIETARY & CONFIDENTIAL: this document contains proprietary and confidential information owned by HELVI S.p.A. and may not be duplicated, communicated to other parties or used for any purpose without express written permission of HELVI S.p.A.  
 Due to constant improvements HELVI S.p.A. reserves the right to amend any of the above without prior notice.

	1	0	2	S/L2		E			C
				V/T2	V1/T5	A	B	H	D
POS.	1	X		X	X	X	X	X	X
	0								
	2		X		X				X

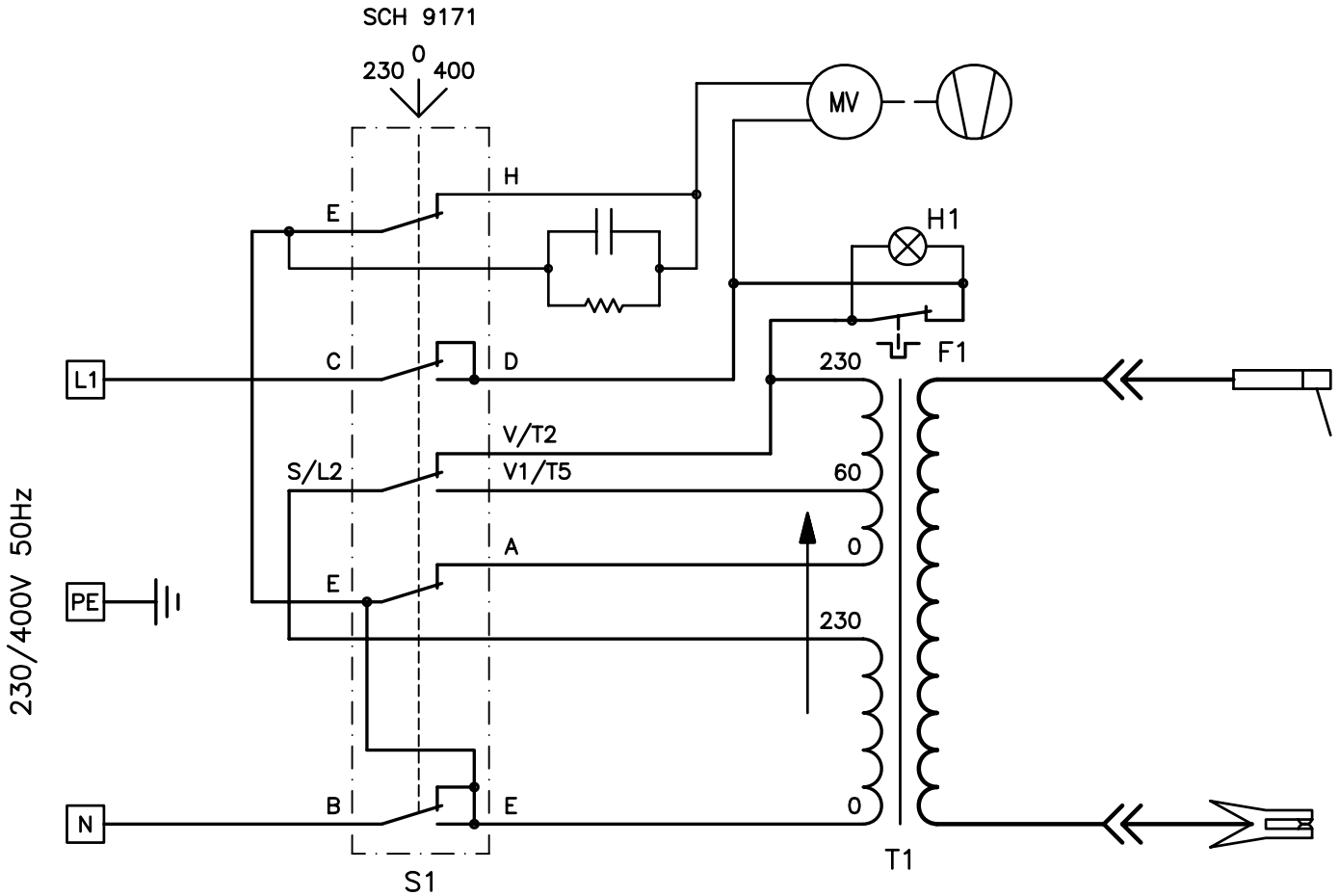

Denomination

NOVA 260N TURBO

Date

24.04.09

Part Number

S9200081



PROPRIETARY & CONFIDENTIAL: this document contains proprietary and confidential information owned by HELVI S.p.A. and may not be duplicated, communicated to other parties or used for any purpose without express written permission of HELVI S.p.A. Due to constant improvements HELVI S.p.A. reserves the right to amend any of the above without prior notice.