

# COMPACT EVO 450 AC/DC

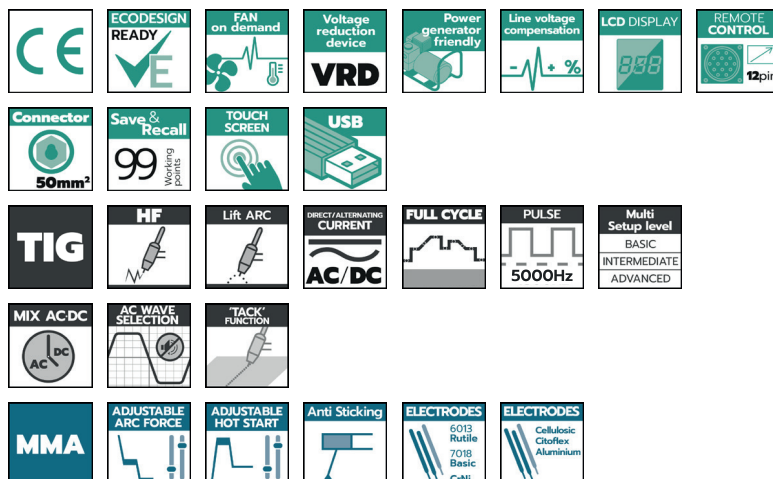

## FEATURES



## TECHNICAL DATA

Input Voltage
Power 60%
No load voltage $U_0$
Amp Min-Max
Duty Cycle 40°
Insulation class
Protection degree
Dimensions (LxWxH)
Weight box/net

COMPACT EVO 450 AC/DC	
400V ± 10% · 50/60 Hz · (3ph)	
TIG	MMA
9,2 KVA	9,2 KVA
55 V	55 V
5 ÷ 450 A	5 ÷ 450 A
450A @ 40% 330A @ 100%	450A @ 40% 360A @ 60% 330A @ 100%
H	
IP 22S	
320x640x520 mm	
48,4 / 51,4 kg	

## STANDARD CONFIGURATION

Part number	Description
99815049K	COMPACT EVO AC/DC 450 · H <sub>2</sub> O
99815049	Power source
99490024KA	Cooler unit XL 400V + tank
99900187	Trolley · 4 wheels UNI